

For more information, copies of this leaflet, keeping up to date,  
or details of how you can get more involved

**visit our website:**

wecanbuildourchurch.org.uk

**follow us on Twitter:**

@strawvic

**send an email**

richard.dormandy@htth.org.uk

**make a phone call**

020 8674 6721

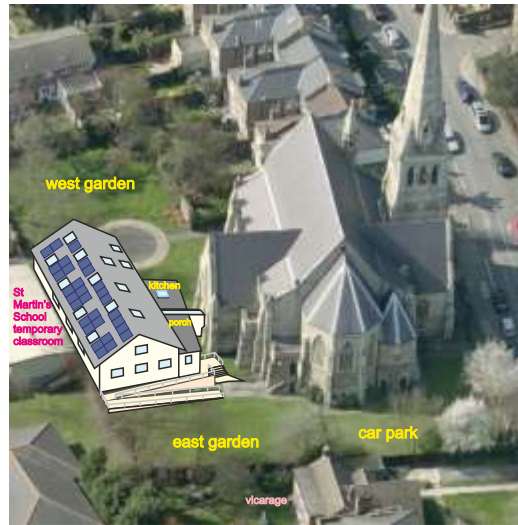

Tulse Hill Neighbourhood Hub in context



# Our Vision for a Neighbourhood Hub



Construction of Victory Community Hall, Norfolk

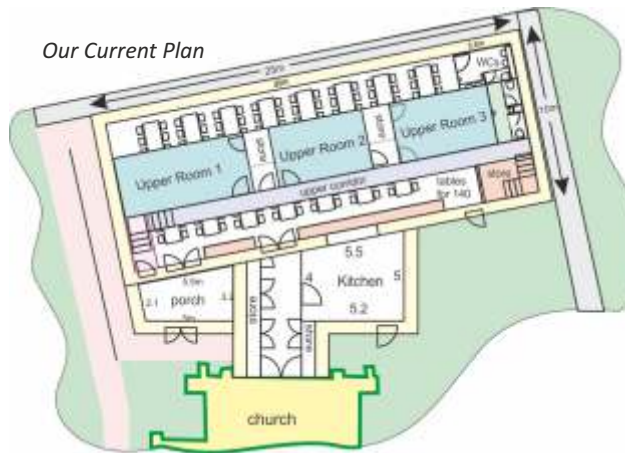

Our Current Plan



and how you can become a  
**Bale Builder**

for more copies of this leaflet, or further details, contact:

email: richard.dormandy@htth.org.uk

web: wecanbuildourchurch.org.uk

follow us on twitter: @strawvic

telephone: 020 8674 6721



Architectural Design by Straw Works  
<http://strawworks.co.uk>



Community Building with Straw Bales in South London



Community Building with Straw Bales in South London



Community Building with Straw Bales in South London

**Living in Tulse Hill** is a great joy to me. It is a place of spirit and potential. Yet there are many pressures on people: social, economic, relational, health-related, and personal. About 16,000 of us live here, in a third of a square mile. Over 33% of children are cited as living in poverty.

**Holy Trinity Church** has been engaging positively with neighbourhood needs for over 150 years; working with others to build a stronger community and empowering folk to overcome the challenges they face.

**Now we plan to develop this work** by building a new Neighbourhood Hub. Local research shows a huge need for affordable, sustainable community spaces. Our aim is to create a place where neighbours can gather, run classes and clubs, weddings & other social events, and where we can also provide for schools, children, youth & elders.

**Our Hub will be unique** as we intend to build it using straw. Straw bales are light, extremely fire-resistant, and immensely strong. Rendered outside and in with lime and clay, they create a self-regulating atmosphere, which will reduce future energy bills by 50-80%.

**Our Hub will be ground breaking** because it will be built to a very high standard by the people of Tulse Hill ourselves. Construction with straw bales is a community project that volunteers of all ages and experience can take part in. Yet with professional design and expert leadership, the final product will be expected to stand for 200 years.

**Environmentally friendly and built by volunteers**, our Neighbourhood Hub is not simply about providing a building; it's about community learning, growing together, and showing the way to a different tomorrow.

**How can you be involved?** There are many ways to get involved in this project. Here in this leaflet we invite your *financial* support as a Bale Builder.

**Our initial fundraising target is £380,000**, which is the equivalent of 95,000 straw bales! As a Bale Builder, we ask you to make a one-off donation, or set up a regular monthly standing order, to help us hit that target.

**Each bale delivered will cost us about £4.** A gift of £40 will help us buy 10 bales, £200 will buy 50 bales, £3,000 will buy 750 bales. Your gift of any amount will directly help build the Tulse Hill Neighbourhood Hub.

**As a Bale Builder** we also ask you to find two other people who will do the same. This way you will bring both financial support, and also help to spread the word.

**In contributing** to this project, you will actively help demonstrate practical solutions to the environmental challenges we face together. By using sustainable, waste, or recycled materials, our Hub will have a very low - maybe negative - carbon impact.

**In supporting** this project, you will also be investing in people and giving hope to a community under pressure. Trained by Straw Works (a global leader in straw bale work) we will learn new skills and meet new people. Community self-build projects are a proven way of developing respect, teamwork, and positive, healthy outlooks.

**We need your help.** We have made a good start but we desperately need your help. £380,000 is a lot of money for ordinary people to find. Every donation will be acknowledged. **Please help us here in Tulse Hill.**

Richard Dormandy  
Vicar, Tulse Hill Parish



Community Building with Straw Bales in South London



Community Building with Straw Bales in South London

## To make a direct donation or set up a standing order...

Our bank details:

Account Name: Holy Trinity & St Matthias PCC  
Reference: Phase 4 - Bale Builder  
Account No: 50392839  
Sort Code: 20-94-67

## Or send a cheque, payable as above, to:

Mr JRF Maddox, Ref: "Phase 4 - Bale Builder"  
69, Claverdale Rd, on reverse.  
Tulse Hill, SW2 2DH.

## Please complete this Gift Aid form if you are a UK taxpayer, and return to the above address.

### For one-off donations

Please treat as a Gift Aid donation this gift of £ \_\_\_\_\_

I confirm I have paid or will pay an amount of Income Tax and / or Capital Gains Tax for each tax year (6 April to 5 April) that is at least equal to the amount of tax that all the charities or Community Amateur Sports Clubs (CASCs) that I donate to will reclaim on my gifts for that tax year. I understand that other taxes such as VAT and Council Tax do not qualify. I understand the charity will reclaim 25p of tax already paid to the government, on every £1 that I give.

### For on-going donations (past, present & future)

Please treat as Gift Aid donations all qualifying gifts of money made  today  in the past 4 years  in the future

*(tick all boxes you wish to apply)*

I confirm I have paid or will pay an amount of Income Tax and / or Capital Gains Tax for each tax year (6 April to 5 April) that is at least equal to the amount of tax that all the charities or Community Amateur Sports Clubs (CASCs) that I donate to will reclaim on my gifts for that tax year. I understand that other taxes such as VAT and Council Tax do not qualify. I understand the charity will reclaim 28p of tax on every £1 that I gave up to 5 April 2008 and will reclaim 25p of tax on every £1 that I give on or after 6 April 2008.

## Your Details (essential for Gift Aid)

Title \_\_\_\_\_ First Name \_\_\_\_\_ Surname \_\_\_\_\_

Full Home Address \_\_\_\_\_

Postcode \_\_\_\_\_

Signature \_\_\_\_\_ Date \_\_\_\_\_

email \_\_\_\_\_